

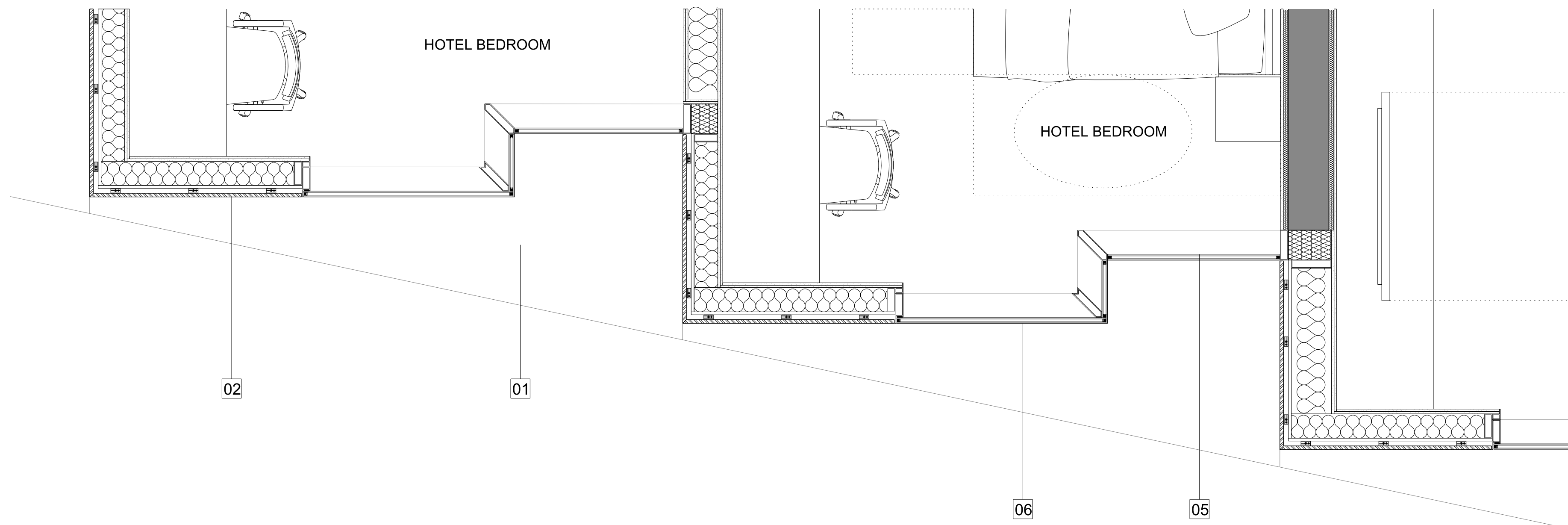

G251
5200-1
Detail
Elevation

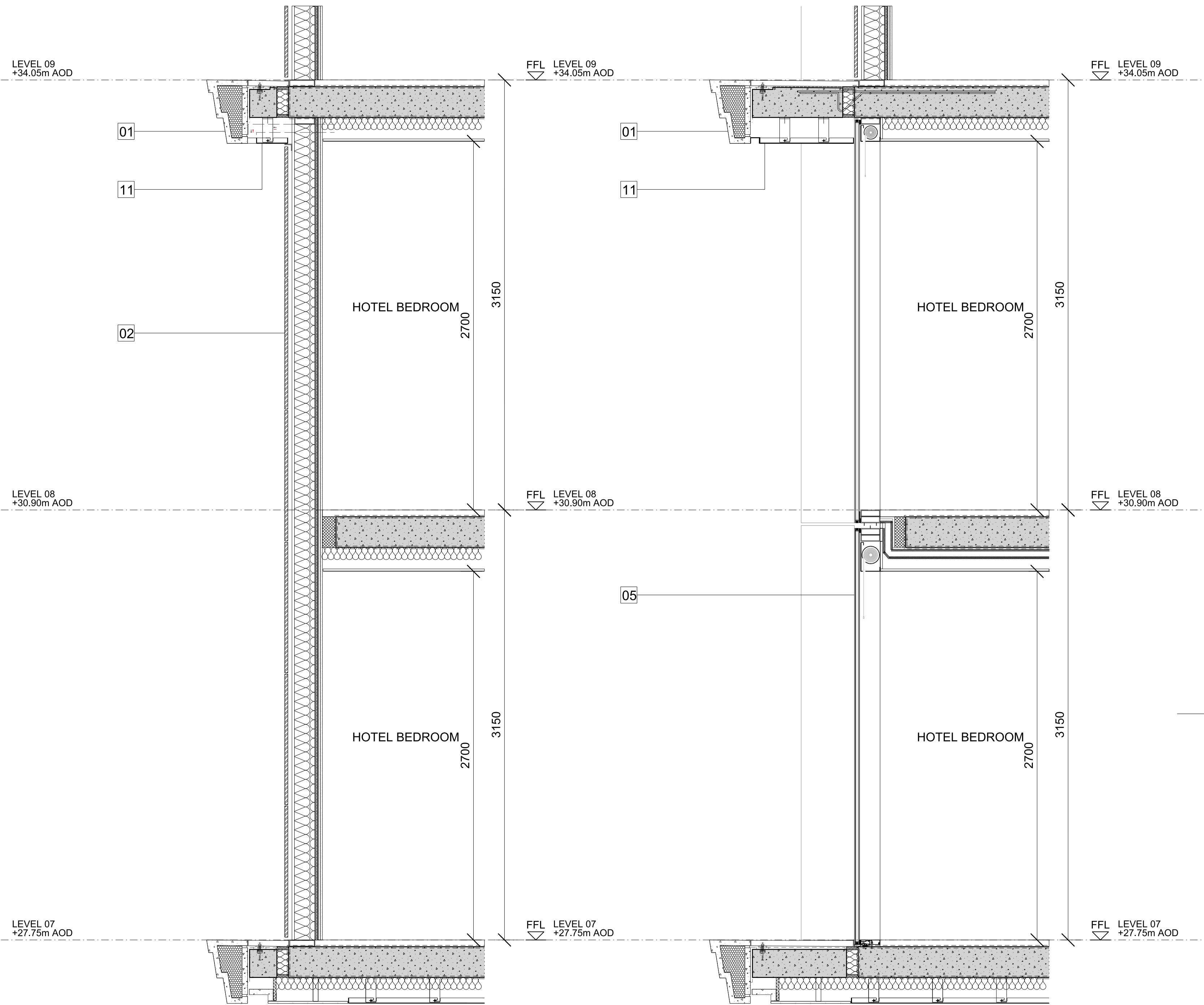

G251
5201-4
Detail
Plan



G251
5201-3
Detail
Section

G251
5201-3
Detail
Section

ELEVATION KEY

- 01 PRE-CAST RECONSTITUTED STONE FLOOR PROFILE
- 02 PORTLAND STONE CLADDING PANELS WITH FILLED JOINTS
- 03 BRONZE FRAME WITH LAMINATED FROSTED GLASS FINS WITH LEAF FRIT PATTERN
- 04 PERFORATED ANODISED BRONZE ALUMINIUM SCREEN/BALUSTRADE WITH LEAF PATTERN
- 05 CLEAR FULL HEIGHT GLAZED UNITS IN ANODISED BRONZE ALUMINIUM FRAME
- 06 BACKPAINTED FULL HEIGHT GLAZED UNITS WITH BRONZE ALUMINIUM FRAME
- 07 CLEAR FULL HEIGHT GLAZED UNITS WITH BRONZE COLOURED LEAF FRIT PATTERN IN GLASS BUILD-UP
- 08 ANODISED BRONZE ALUMINIUM FASCIA TO ROLLER BLIND BOX
- 09 LAMINATED GLASS FINS WITH BRONZE COLOURED LEAF FRIT PATTERN IN GLASS BUILD-UP
- 10 GLASS BALUSTRADE
- 11 BRONZE MOSAIC TILE INLAY TO PRE-CASE CONCRETE SOFFIT PANEL
- 12 ANODISED BRONZE ALUMINIUM SOFFIT PANEL
- 13 ANODISED BRONZE ALUMINIUM CLADDING PANEL
- 14 CLEAR STRUCTURAL SILICONE GLAZING SYSTEM WITH LAMINATED GLASS MULLIONS
- 15 TEXTURED AND PATTERNED BRONZE CLADDING PANELS
- 16 AUTOMATED GLASS REVOLVING DOORS WITH GLASS ROOF
- 17 CLEAR FULL HEIGHT SINGLE GLAZED FIXED PANEL WITH BRONZE LEAF FRIT PATTERN
- 18 CLEAR FULL HEIGHT SINGLE GLAZED SLIDING DOOR
- 19 CLEAR FULL HEIGHT DOUBLE GLAZED SLIDING DOOR
- 20 CLEAR FULL HEIGHT DOUBLE GLAZED UNITS WITH EXPRESSED BRONZE ANODISED ALUMINIUM CAPPING TO MULLION AND TRANSOM
- 21 BRONZE ANODISED ALUMINIUM PLANTING SCREEN
- 22 AUTOMATED GLASS SLIDING ENTRANCE DOORS
- 23 RECONSTITUTED STONE REVEAL
- 24 CLEAR FULL HEIGHT SINGLE GLAZED DOORS

This drawing is copyright
Do not scale off dimensions.
All dimensions to be checked on site by contractor.
Contractor to report any dimensional discrepancies,
errors or omissions prior to commencing on site.

NOTE:

NORTH

Rev	Date	Description	Rev	Date	Description
-	15/05/2018	Full Planning Application			
A	11/01/2019	GLA Callin Amendments			

500 0 500 1000 2000mm

Project Title
Kensington Forum Hotel
Kensington, London

Status
PLANNING

Drawing Title
Towers - Cromwell Road Staggered
Bay Windows

Job No 10106	Scale 1:20@ A0	Date JAN 2019
Drawing No 10106-A-DRG-Z0-G251-5201-PL	Revision A	

simpsonhaugh

MANCHESTER
Riverside, 4 Commercial St
M4 6DY Tel: 0161 835 2345
www.simpsonhaugh.com

LONDON
2nd Roberts Place
LONDON EC1A 1BB
Tel: 020 7591 9600
mail@simpsonhaugh.com